

Reinach, CH – Visitor Information



Address:

Thermo Fisher Scientific
Neuhofstrasse 11
CH-4153 Reinach

Opening hours: Mon – Fri 8.00 am – 12.00 am /
1.00 pm – 4.30 pm

Email: Events.ch@thermofisher.com

Telephone: **+ 41 (0) 61 716 77 00**



Do you need Internet access?
Ask at the reception for your WLAN access data.

Directions



By car
From Basel

Take the H18 Autobahn from Basel following the signs for Delémont. Take the exit for Dornach/Reinach, turning right in the direction of Reinach and then take the 3rd exit left at the next roundabout. About 300 m further on you will find the Thermo Scientific Demo Centre.



By train/bus

Arrival from west station (Westbahnhof):

The tram Nr. 11 runs directly from the city center and SBB Bahnhof to Reinach (Station Süd, 20min), which is next to the Thermo Scientific Demo Centre. Click [here](#) for more information about the Basel transport system.



By air

Basel airport:

The easiest way of getting to the center of Basel or the Thermo Scientific Demo center from the airport is via taxi. There is also a shuttle available for transfers from the terminal to the Basel SBB train station. From there please follow the directions above (by public transportation). For additional information's please visit [airport website](#).



Taxis

Arrival airport Basel:

Taxis are available outside Basel airport and Basel SBB train station. The cost of travel to the Thermo Scientific Demo Centre is approximately CHF 95 from the airport and CHF 55 from Basel SBB dependent upon traffic. No Pre-booking is necessary and many taxis will accept credit cards.

If you would like to pre-book a taxi we recommend [Taxi-Zentrale AB Basel](#), Tel: + 41 (0) 61 222 22 22.



Parking

You can park your car in the underground car park. You can ring the bell at the parking barriers and our receptionist will grant you access to the underground car park. Thermo Fisher Scientific parking spaces are available in the U underground car park.

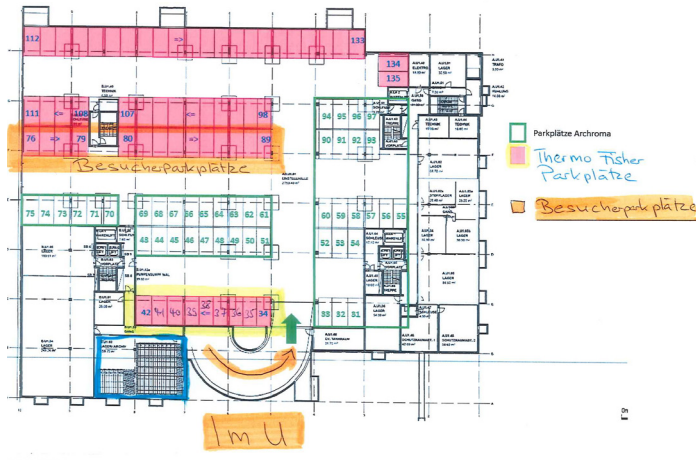

Registration

Since October 1st, 2023, we have a new registration system, Traction Guest[®], at the Reception in Reinach. All visitors must sign in using this system before they enter the building.

Please arrive at least 10 minutes prior to your scheduled appointment in order to complete the registration process.



Hotel recommendation

We recommend that our customers stay in the centre of Basel or near the Basel SBB train station during their visit to our Demo Centre.

The following Hotels can be found in these areas:

- **Gaia Hotel Basel**
Centralbahnstrasse 13-15
CH-4002 Basel
Tel: +41 (0) 61 225 13 13
<https://www.gaiahotel.ch/>
- **Hyperion Hotel Basel**
Messeplatz 12, 4058 Basel, Switzerland
Tel: +41 (0)61 560 40 00
[Hotel website](#)

Otherwise you can stay at the following hotel near Reinach:

- **Hotel Gasthof Mühle**
Hauptstrasse 61
4147 Aesch
Tel: +41 61 756 10 10
<https://gasthofmuehle.ch/>











© Pavlo Petrenko, Flickr, 2015

Safety information

At Thermo Fisher Scientific your Safety is of utmost importance to us. That is why we request that you inform yourselves about our safety rules at this facility.



	Behavior in case of emergency: fire alarm and evacuation Go immediately to the assembly point (Kägenstrasse 18).
	Smoking is not permitted inside the building or in the Tech Center.
	Photo, sound and video recordings are not permitted without express permission.
	Follow instructions by Thermo Fisher Scientific staff.
	Do not eat or drink in the Demo Center.
	Safety goggles and lab coat must be worn in the Demo Center.
	Closed-toed shoes must be worn in the Demo Center.
	Touching any object in the Demo Center is not permitted without express permission.